

**UNIVERSAL  
SHOWER BASE**



**AUSTRALIAN MADE AND OWNED**

# THE BENEFITS

## UNIVERSAL SHOWER BASE OFFERS A RANGE OF STANDARD AND CUSTOM OPTIONS TO MEET YOUR SPACE AND/OR DESIGN REQUIREMENTS.

Whether you are building, renovating, extending, or creating something new The Universal Shower Base has a range of standard and custom size options to suit your space and design requirements.

**MANUFACTURED IN**

**AUSTRALIA SINCE 1992**

The original multi-use shower base is quick and easy to install with a pre-formed design ensuring each product is manufactured with the correct fall every time. This makes it an ideal option for installation onto any substrate or concrete slab and relieves the stress of potential leaks and cracks that can be caused by screeding and other methods.

## FEATURES

- Fully Concealed
- Multiple grate styles and locations
- Will not crack or shrink
- Suitable for any wet area
- Correct fall every time
- Light weight and strong
- Easily modified
- Custom options available
- Suitable for hob construction
- NCC/BCA 3.8.1 and AS 3470 compliant

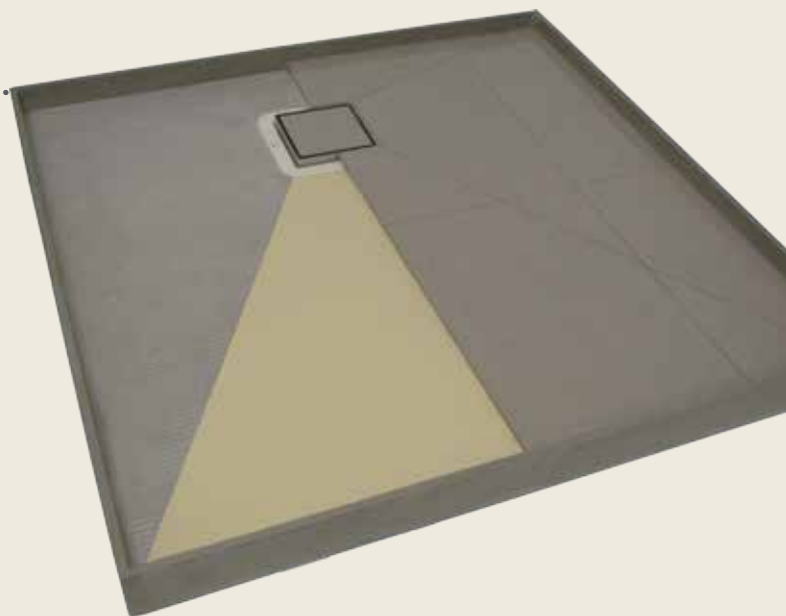

## CENTRE AND

## REAR WASTE OPTIONS

910 x 910  
1010 x 1010\*  
1230 x 910  
1220 x 1010  
1220 x 1220\*  
1380 x 910  
1520 x 910  
1520 x 1010  
1670 x 910  
1820 x 910  
1820 x 1010

\*Only available in centre waste



**PLAIN (P)**



**SLOTTED (Q)**



**TILE IN (S)**  
Tile not included  
Designed for 10mm tile



**PUDDLE  
FLANGE (TTPF)**



**MATT BLACK  
AVAILABLE IN  
P, Q & S**



**VINYL (V)**

## CHANNEL GRATE OPTIONS

950 x 910  
950 x 1010  
1050 x 910  
950 x 1230  
1250 x 910  
1050 x 1010  
1250 x 1010  
1520 x 910  
1520 x 1010  
1820 x 910  
1820 x 1010  
2150 x 1010



**SLOTTED (OG) - AVAILABLE IN STAINLESS STEEL & MATT BLACK**



**TILE IN (TG) - AVAILABLE IN STAINLESS STEEL & MATT BLACK**  
Tile not included



**LINEAR (LG) - AVAILABLE IN STAINLESS STEEL & MATT BLACK**



**PLAIN (PG) - AVAILABLE IN STAINLESS STEEL & MATT BLACK**

## SHOWER NICHE STANDARD SIZES

360 x 360 x 105  
360 x 420 x 105  
360 x 660 x 105  
360 x 900 x 105

External measurements



# CUSTOM BASES & NICHEs



---

## UNIVERSAL SHOWER BASE HAVE THE SOLUTION FOR YOU

---

If your shower base is truly unique and you cannot find a size or waste location to suit your needs, choose a Custom made Universal Shower Base.

**YOUR BATHROOM DREAM**

**CAN BECOME A REALITY**

Our specialised machinery offers endless variations to suit the smallest or the largest shower space, with the correct fall for wherever you choose your waste position.



We can also make Custom shower niches, alongside our standard sizes, if you have a special need. No size is too big or too small.

For more information about our custom base and niche options, visits our website or talk to one of our friendly showroom consultants.

[UNIVERSALSHOWERBASE.COM](https://www.universalshowerbase.com)

# HOW TO INSTALL

## LEVEL ENTRY ONTO TIMBER FLOOR FOR STANDARD SHOWER BASES

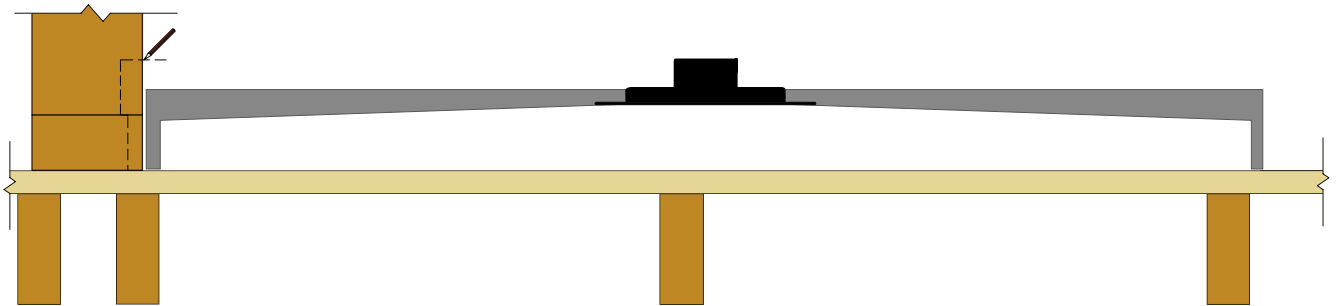

Mark out the base position on both the floor and on the wall studs at a height of 90mm above the existing floor. Prior to cutting the floor, reduce the perimeter of the cut-out by 8mm or by the amount of the checkin.

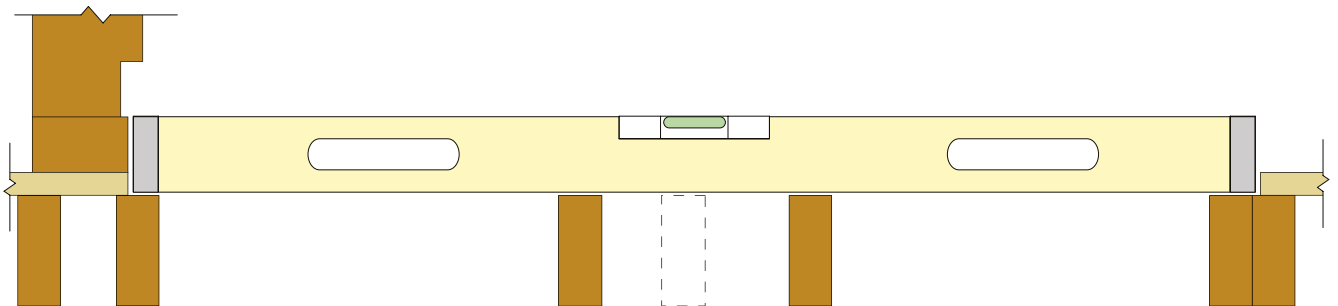

Cut out the flooring and check out the wall studs and bottom wall plate. In accordance with the AS1684

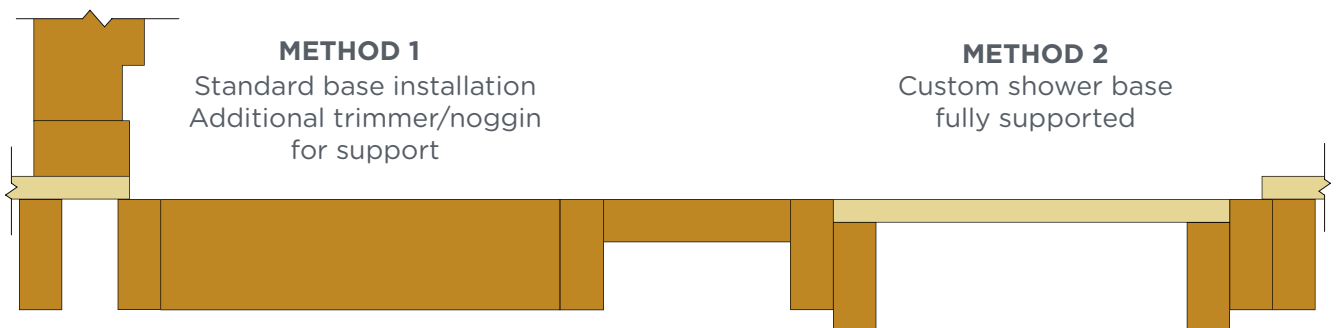

You can use two different methods to support the shower base:

Method 1: Self supporting directly onto floor joists.

Method 2: Fully supported with flooring fitted between floor joists.

\*Custom Shower Bases must be installed using method 2

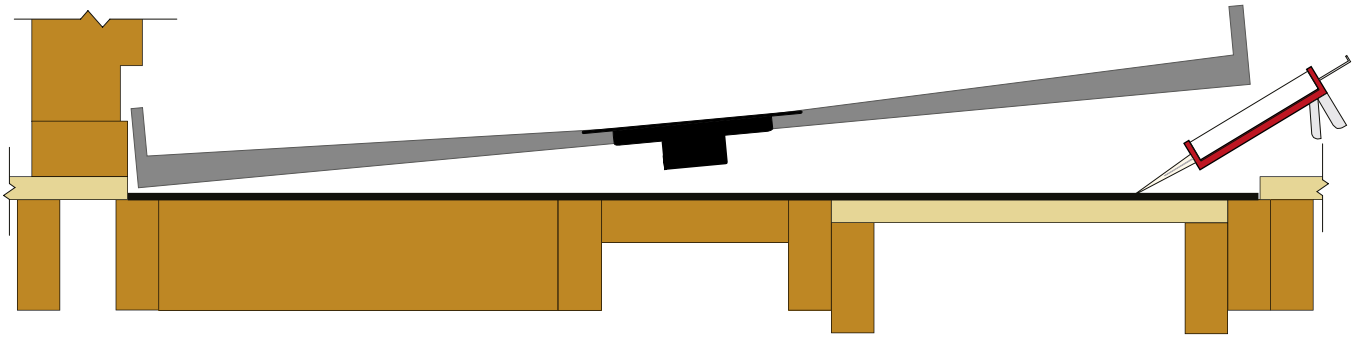

Glue the shower base into position by applying a “polyurethane sealant/adhesive” to all trimmers, joists and exposed flooring as illustrated below. Now place base into position without sliding it across adhesive beads. Weight each corner down, using weights no heavier than 5kg per corner, (no more than 30kg in total) for a minimum of 24 hours.

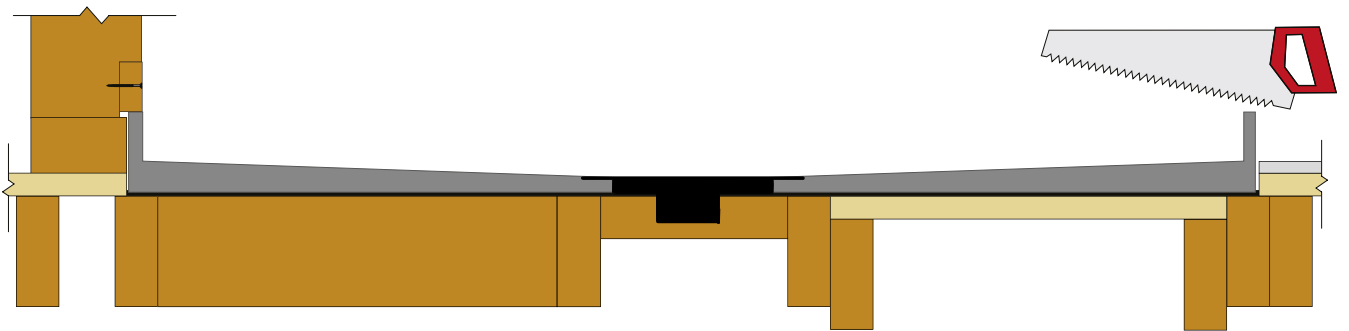

Install the floor sheeting and trim the shower base lip. Trimming can be done using a multi-tool, handsaw, hacksaw blade, etc.

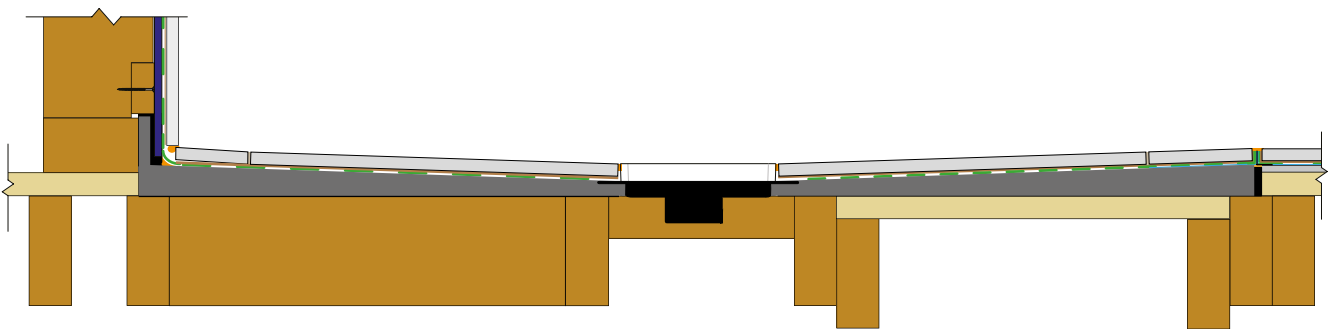

Waterproof the shower base and shower area including waterstops to comply with the NCC/BCA and AS3740.

**COMPLETE INSTRUCTIONS FOR TIMBER, CONCRETE,  
CUSTOM BASES AND NICHE ARE AVAILABLE AT  
[WWW.UNIVERSALSHOWERBASE.COM](http://WWW.UNIVERSALSHOWERBASE.COM)**

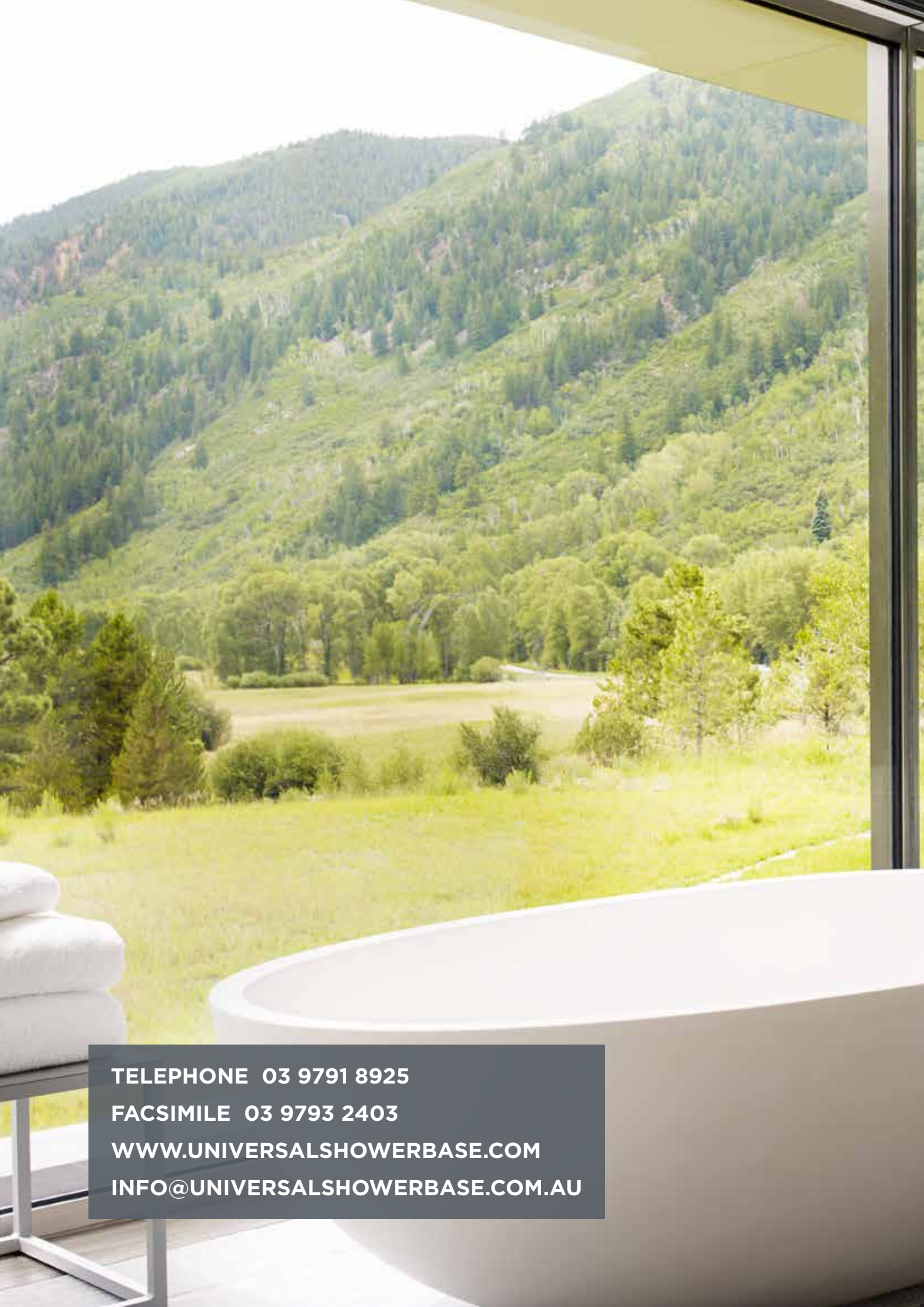

**TELEPHONE 03 9791 8925**

**FACSIMILE 03 9793 2403**

**[WWW.UNIVERSALSHOWERBASE.COM](http://WWW.UNIVERSALSHOWERBASE.COM)**

**[INFO@UNIVERSALSHOWERBASE.COM.AU](mailto:INFO@UNIVERSALSHOWERBASE.COM.AU)**